

东方市滨海片区(一期)棚户区改造(AC)区基础设施配套项目宗地图

海南道铭测绘科技有限公司

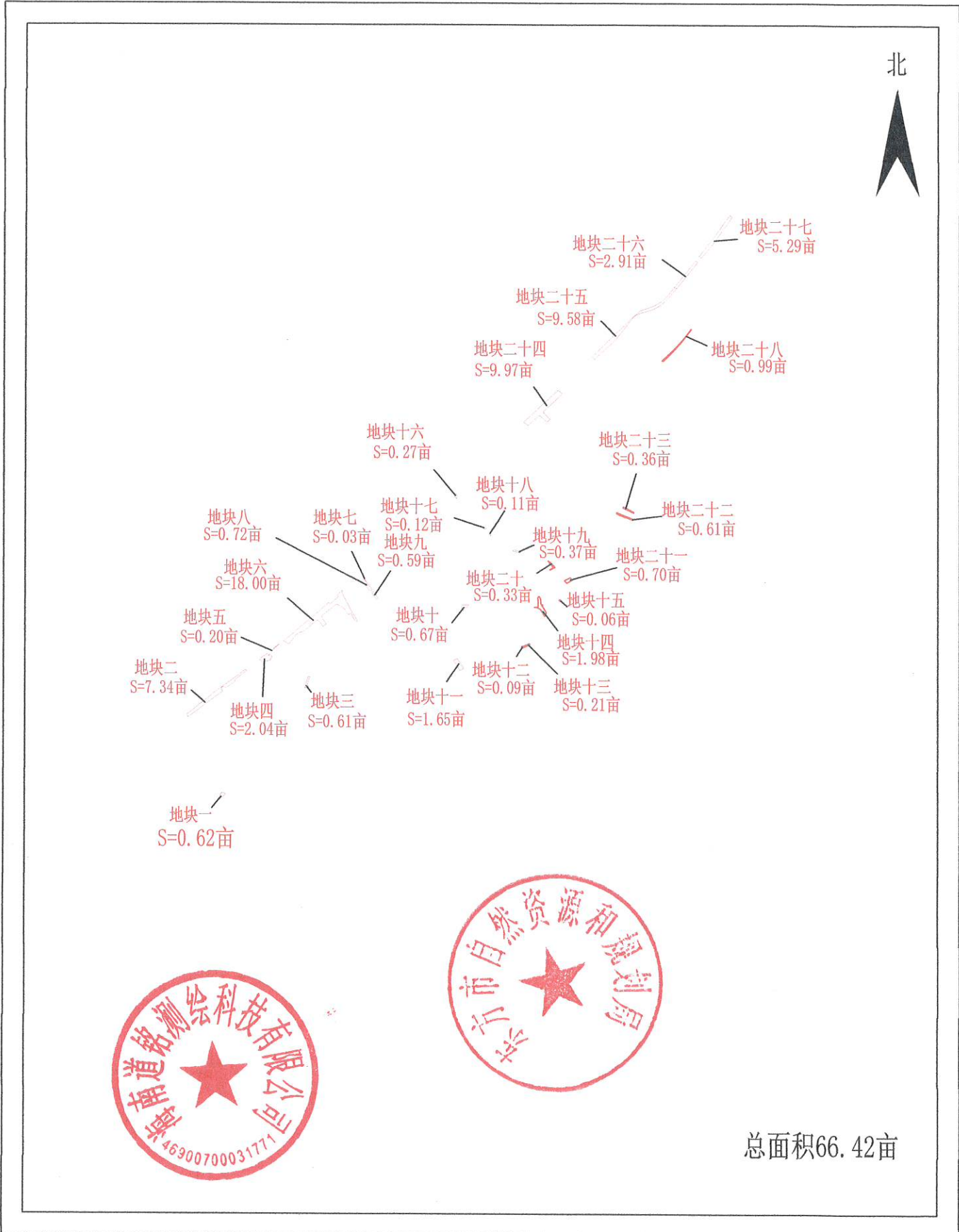

绘图日期: 2024年3月1日

绘图员: 王熊帅

1:5000

2000国家大地坐标系(109°)

检查员: 单松柏

地块二界址点坐标表

点号	X	Y	边长
J1	2113385.167	461114.812	14.04
J2	2113394.049	461125.683	63.25
J3	2113434.050	461174.672	43.05
J4	2113459.605	461209.322	26.63
J5	2113476.689	461229.753	16.26
J6	2113486.318	461242.854	9.44
J7	2113492.317	461250.141	175.91
J8	2113596.791	461391.672	8.49
J9	2113590.346	461397.206	68.42
J10	2113549.768	461342.111	4.04
J11	2113546.095	461340.439	6.41
J12	2113539.740	461341.292	5.11
J13	2113536.843	461337.084	46.39
J14	2113509.882	461299.339	12.95
J15	2113515.790	461287.816	8.80
J16	2113512.789	461279.544	5.64
J17	2113507.595	461277.356	10.52
J18	2113497.669	461280.855	4.68
J19	2113493.869	461283.579	1.21
J20	2113493.176	461282.592	

地块一界址点坐标表

点号	X	Y	边长
J1	2113012.136	461276.156	7.52
J2	2113018.898	461279.453	1.31
J3	2113020.009	461280.146	6.21
J4	2113018.226	461286.097	9.90
J5	2113016.372	461295.823	3.94
J6	2113013.183	461298.133	4.92
J7	2113008.536	461296.518	7.43
J8	2113003.700	461290.882	15.59
J9	2112995.203	461277.816	6.28
J10	2112990.578	461273.567	3.20
J11	2112989.243	461270.654	1.08
J12	2112990.322	461270.694	7.52
J13	2112997.770	461271.753	7.52
J14	2113006.068	461273.580	7.52
J1	2113012.136	461276.156	

地块四界址点坐标表

点号	X	Y	边长
J1	2113644.913	461456.334	12.05
J2	2113652.127	461465.981	28.19
J3	2113669.289	461488.340	0.57
J4	2113668.986	461488.823	3.18
J5	2113668.756	461491.997	1.74
J6	2113669.807	461493.378	3.48
J7	2113666.519	461494.524	8.63
J8	2113659.926	461500.095	3.01
J9	2113662.243	461502.013	2.47
J10	2113664.052	461500.330	4.50
J11	2113667.422	461503.313	14.77
J12	2113667.622	461514.369	2.70
J13	2113655.834	461512.348	2.22
J14	2113653.613	461512.229	1.47
J15	2113652.234	461512.751	3.18
J16	2113649.058	461512.682	1.27
J17	2113648.553	461511.515	3.23
J18	2113647.296	461508.536	8.38
J19	2113639.406	461505.717	2.76
J20	2113640.169	461503.065	

地块四界址点坐标表

点号	X	Y	边长
J20	2113640.169	461503.065	3.69
J21	2113639.203	461499.506	5.58
J22	2113634.411	461496.653	11.16
J23	2113637.205	461485.844	1.28
J24	2113636.002	461485.409	3.16
J25	2113636.972	461482.398	12.22
J26	2113625.279	461478.858	4.67
J27	2113625.782	461474.212	0.37
J28	2113625.558	461473.915	10.25
J29	2113633.249	461467.138	11.02
J30	2113642.176	461460.680	3.91
J31	2113639.813	461457.571	5.25
J1	2113644.913	461456.334	

地块五界址点坐标表

点号	X	Y	边长
J1	2113684.595	461508.282	8.95
J2	2113690.046	461515.383	44.58
J3	2113717.626	461550.401	15.82
J4	2113706.683	461538.974	33.48
J5	2113683.528	461514.793	2.34
J6	2113681.763	461513.258	5.73
J1	2113684.595	461508.282	

地块二界址点坐标表

点号	X	Y	边长
J20	2113493.176	461282.592	47.17
J21	2113465.101	461244.686	47.17
J22	2113437.026	461206.779	47.17
J23	2113408.951	461168.872	60.66
J24	2113372.955	461120.052	13.29
J1	2113385.167	461114.812	

地块三界址点坐标表

点号	X	Y	边长
J1	2113562.554	461684.465	8.60
J2	2113565.227	461692.640	39.27
J3	2113528.009	461680.108	11.03
J4	2113518.508	461685.717	19.58
J5	2113510.303	461667.944	1.51
J6	2113511.665	461668.588	53.31
J1	2113562.554	461684.465	

地块六界址点坐标表

点号	X	Y	边长
J1	2113731.512	461567.938	57.61
J2	2113767.720	461612.747	62.28
J3	2113807.464	461660.693	62.28
J4	2113847.803	461708.139	62.28
J5	2113888.733	461755.077	35.04
J6	2113912.092	461781.199	1.77
J7	2113910.746	461782.348	6.08
J8	2113906.117	461786.297	1.36
J9	2113904.892	461786.897	2.00
J10	2113906.023	461788.550	2.58
J11	2113907.785	461790.434	46.56
J12	2113938.194	461825.665	9.72
J13	2113945.962	461819.836	8.12
J14	2113951.427	461825.845	0.64
J15	2113951.918	461825.432	24.26
J16	2113968.202	461843.416	4.92
J17	2113964.742	461846.918	8.08
J18	2113959.188	461841.044	6.23
J19	2113963.962	461844.443	7.46
J20	2113947.260	461847.721	

地块六界址点坐标表

点号	X	Y	边长
J20	2113947.260	461847.721	39.36
J21	2113912.261	461865.724	54.35
J22	2113863.928	461890.585	45.76
J23	2113824.811	461914.326	6.70
J24	2113821.205	461908.684	12.16
J25	2113829.853	461900.134	27.07
J26	2113854.065	461888.036	7.77
J27	2113861.403	461885.474	14.23
J28	2113855.100	461872.719	35.05
J29	2113883.535	461852.217	4.56
J30	2113886.503	461848.751	1.33
J31	2113887.365	461847.744	4.70
J32	2113889.492	461843.558	13.57
J33	2113895.641	461831.459	6.73
J34	2113899.267	461825.790	5.50
J35	2113902.653	461821.460	7.13
J36	2113902.450	461814.335	21.36
J37	2113888.177	461798.448	7.86
J38	2113883.335	461792.255	21.31
J39	2113871.345	461774.635	

地块六界址点坐标表

点号	X	Y	边长
J39	2113871.345	461774.635	34.47
J40	2113848.604	461748.736	7.46
J41	2113841.313	461747.153	4.65
J42	2113837.545	461749.870	33.84
J43	2113810.098	461769.659	20.01
J44	2113799.201	461752.878	29.30
J45	2113822.969	461735.742	5.36
J46	2113827.315	461732.608	8.13
J47	2113827.596	461724.485	3.51
J48	2113825.308	461721.826	37.03
J49	2113801.325	461693.609	19.30
J50	2113788.827	461678.900	29.01
J51	2113770.291	461656.589	5.21
J52	2113772.263	461651.768	2.27
J53	2113774.157	461650.509	8.26
J54	2113769.217	461643.886	7.93
J55	2113764.386	461637.595	9.31
J56	2113761.982	461628.596	48.27
J57	2113724.328	461598.393	5.89
J58	2113719.730	461594.705	

地块六界址点坐标表

点号	X	Y	边长
J58	2113719.730	461594.705	5.87
J59	2113716.063	461590.123	27.03
J1	2113731.512	461567.938	

地块七界址点坐标表

点号	X	Y	边长
J1	2114021.254	461945.013	6.58
J2	2114026.766	461948.612	5.78
J3	2114021.226	461946.962	4.69
J4	2114017.420	461949.707	14.19
J5	2114005.910	461958.006	13.03
J6	2114015.723	461949.434	0.70
J7	2114016.254	461948.970	4.00
J8	2114019.263	461946.341	0.39
J9	2114019.558	461946.083	2.00
J1	2114021.254	461945.013	

地块八界址点坐标表

点号	X	Y	边长
J1	2113997.094	461948.202	13.26
J2	2114003.138	461960.004	38.26
J3	2113972.108	461982.377	11.54
J4	2113965.337	461973.031	40.31
J1	2113997.094	461948.202	

地块九界址点坐标表

点号	X	Y	边长
J1	2113956.791	461979.712	11.13
J2	2113963.682	461988.452	37.95
J3	2113932.901	462010.645	9.65
J4	2113926.980	462003.020	37.84
J1	2113956.791	461979.712	





地块十四界址点坐标表

点号	X	Y	边长
J1	2113939.038	462766.863	8.31
J2	2113943.283	462774.005	16.51
J3	2113928.321	462780.983	21.27
J4	2113907.050	462780.782	9.23
J5	2113903.998	462789.493	5.68
J6	2113903.396	462783.844	40.50
J7	2113868.783	462804.874	10.30
J8	2113858.692	462802.810	4.00
J9	2113859.244	462798.844	9.71
J10	2113849.541	462798.511	10.97
J11	2113859.094	462793.117	28.40
J12	2113883.443	462778.499	16.15
J13	2113891.005	462764.224	13.01
J14	2113890.708	462751.220	2.12
J15	2113892.826	462751.253	17.61
J16	2113892.064	462768.843	16.74
J17	2113908.741	462767.351	1.50
J18	2113909.793	462768.416	15.74
J19	2113925.536	462768.374	13.59
J1	2113939.038	462766.863	

地块十六界址点坐标表

点号	X	Y	边长
J1	2114413.868	462371.216	3.16
J2	2114416.018	462373.531	10.53
J3	2114423.180	462381.245	9.76
J4	2114415.714	462387.529	3.22
J5	2114413.438	462385.252	14.14
J6	2114399.351	462384.079	19.40
J1	2114413.868	462371.216	

地块十五点坐标表

点号	X	Y	边长
J1	2113926.478	462864.223	6.17
J2	2113928.163	462870.160	9.32
J3	2113920.466	462875.423	3.51
J4	2113919.537	462872.034	5.00
J5	2113925.536	462868.651	5.50
J1	2113926.478	462864.223	

地块十三界址点坐标表

点号	X	Y	边长
J1	2113711.061	462702.565	5.92
J2	2113705.966	462705.587	26.77
J3	2113717.492	462729.746	3.71
J4	2113721.032	462728.623	12.22
J5	2113717.514	462716.924	15.74
J1	2113711.061	462702.565	

地块十二界址点坐标表

点号	X	Y	边长
J1	2113707.452	462691.347	7.52
J2	2113700.335	462693.785	9.03
J3	2113704.224	462701.936	2.68
J4	2113706.741	462701.012	3.15
J5	2113709.150	462698.975	2.79
J6	2113709.796	462696.260	5.44
J1	2113707.452	462691.347	

地块十一界址点坐标表

点号	X	Y	边长
J1	2113641.742	462370.393	4.69
J2	2113643.889	462374.561	15.41
J3	2113651.114	462388.175	4.17
J4	2113647.874	462390.534	33.65
J5	2113619.806	462409.089	16.57
J6	2113605.632	462417.991	2.85
J7	2113604.449	462415.394	1.58
J8	2113602.931	462415.835	16.87
J9	2113595.925	462400.486	18.89
J10	2113611.833	462390.305	32.43
J11	2113638.855	462372.377	3.50
J1	2113641.742	462370.393	

地块十界址点坐标表

点号	X	Y	边长
J1	2113901.499	462412.500	1.27
J2	2113901.406	462413.784	15.27
J3	2113902.080	462429.019	6.41
J4	2113902.296	462435.427	6.59
J5	2113902.518	462442.016	40.15
J6	2113873.542	462414.224	10.79
J7	2113884.085	462416.511	9.17
J8	2113885.099	462407.398	17.18
J1	2113901.499	462412.500	

地块二十界址点坐标表

点号	X	Y	边长
J1	2114109.540	462812.893	6.17
J2	2114106.459	462818.235	6.55
J3	2114101.994	462823.031	17.73
J4	2114089.873	462835.967	13.91
J5	2114079.229	462844.925	24.92
J6	2114067.819	462822.772	1.10
J7	2114067.072	462821.960	1.33
J8	2114068.134	462821.163	21.89
J9	2114080.484	462839.231	3.90
J10	2114082.874	462836.153	18.56
J11	2114095.302	462822.368	2.84
J12	2114097.288	462820.335	2.65
J13	2114099.931	462820.199	2.44
J14	2114102.151	462819.176	0.54
J15	2114102.667	462819.005	0.65
J16	2114103.005	462818.450	8.58
J1	2114109.540	462812.893	

地块二十二界址点坐标表

点号	X	Y	边长
J1	2114337.000	463137.504	53.31
J2	2114316.460	463186.697	29.91
J3	2114304.937	463214.294	3.81
J4	2114301.188	463213.642	35.60
J5	2114314.599	463180.666	4.97
J6	2114313.272	463176.507	28.70
J7	2114325.858	463150.712	15.98
J8	2114332.864	463136.353	4.29
J1	2114337.000	463137.504	

地块二十三界址点坐标表

点号	X	Y	边长
J1	2114363.796	463167.627	4.72
J2	2114359.542	463165.584	57.74
J3	2114335.318	463217.997	3.84
J4	2114339.143	463218.347	48.27
J5	2114360.348	463174.982	8.12
J1	2114363.796	463167.627	

地块二十一界址点坐标表

点号	X	Y	边长
J1	2114018.280	462890.496	16.15
J2	2114005.976	462900.958	30.82
J3	2114019.951	462928.425	15.14
J4	2114031.485	462918.617	31.07
J1	2114018.280	462890.496	

地块十九界址点坐标表

点号	X	Y	边长
J1	2114156.771	462648.384	7.62
J2	2114162.206	462653.723	13.01
J3	2114158.699	462666.254	21.26
J4	2114153.050	462686.751	8.48
J5	2114147.003	462680.810	17.02
J6	2114151.636	462664.434	14.82
J7	2114155.958	462650.255	2.04
J1	2114156.771	462648.384	

地块十八界址点坐标表

点号	X	Y	边长
J1	2114235.062	462534.318	8.17
J2	2114240.366	462540.535	6.55
J3	2114235.416	462544.821	1.52
J4	2114234.428	462543.660	9.02
J5	2114225.411	462543.574	13.37
J1	2114235.062	462534.318	

地块十七界址点坐标表

点号	X	Y	边长
J1	2114265.520	462507.436	9.63
J2	2114264.204	462516.977	1.89
J3	2114265.429	462518.417	7.07
J4	2114260.117	462523.087	8.40
J5	2114254.626	462516.728	10.00
J6	2114262.252	462510.257	4.32
J1	2114265.520	462507.436	



地块二十四界址点坐标表

点号	X	Y	边长
J1	2114759.274	462700.244	10.67
J2	2114766.561	462708.038	0.66
J3	2114767.097	462708.429	205.94
J4	2114908.760	462857.899	26.51
J5	2114893.513	462879.580	2.98
J6	2114891.464	462877.418	117.49
J7	2114810.645	462792.144	7.98
J8	2114802.699	462791.423	5.18
J9	2114799.103	462795.158	37.79
J10	2114772.897	462822.379	8.16
J11	2114767.403	462816.341	11.85
J12	2114759.146	462807.846	38.68
J13	2114785.977	462779.978	4.82
J14	2114789.318	462776.507	7.63
J15	2114788.626	462768.912	65.47
J16	2114743.586	462721.390	26.33
J1	2114759.274	462700.244	
S=6645.1 平方米 合9.9677亩			

地块二十五界址点坐标表

点号	X	Y	边长
J1	2115065.187	463022.186	13.43
J2	2115074.792	463031.577	15.32
J3	2115085.909	463042.114	142.39
J4	2115186.836	463142.553	7.86
J5	2115191.304	463149.017	5.95
J6	2115195.163	463153.542	16.06
J7	2115206.588	463164.833	8.10
J8	2115211.359	463171.379	33.23
J9	2115235.471	463194.251	72.15
J10	2115282.391	463249.066	48.46
J11	2115297.359	463295.156	15.89
J12	2115302.540	463310.172	46.59
J13	2115326.700	463350.012	35.46
J14	2115351.097	463375.750	53.15
J15	2115392.383	463409.219	2.15
J16	2115390.617	463410.445	9.72
J17	2115387.952	463419.789	0.71
J18	2115387.407	463419.330	35.52
J19	2115360.164	463396.538	35.08
J20	2115334.612	463372.505	

地块二十五界址点坐标表

点号	X	Y	边长
J20	2115334.612	463372.505	22.81
J21	2115318.457	463356.402	12.37
J22	2115310.208	463347.190	12.11
J23	2115303.325	463337.221	11.78
J24	2115297.602	463326.922	10.42
J25	2115292.422	463317.885	11.76
J26	2115287.855	463307.044	11.64
J27	2115284.239	463295.980	16.97
J28	2115279.294	463279.750	19.61
J29	2115273.858	463260.905	22.29
J30	2115266.990	463239.701	8.18
J31	2115263.415	463232.338	11.19
J32	2115257.595	463222.780	6.56
J33	2115253.517	463217.645	6.37
J34	2115249.233	463212.934	9.06
J35	2115242.396	463206.984	12.23
J36	2115232.999	463199.159	13.07
J37	2115222.857	463190.920	15.63
J38	2115210.688	463181.118	49.60
J39	2115171.942	463150.150	

地块二十五界址点坐标表

点号	X	Y	边长
J39	2115171.942	463150.150	16.57
J40	2115158.817	463140.041	15.49
J41	2115146.651	463130.450	8.86
J42	2115139.817	463124.817	13.24
J43	2115130.299	463115.619	28.59
J44	2115111.544	463094.047	44.85
J45	2115080.821	463061.366	11.73
J46	2115072.786	463052.820	26.56
J47	2115054.223	463033.819	15.99
J1	2115065.187	463022.186	
S=6385.3 平方米 合9.5779亩			



地块二十七界址点坐标表

点号	X	Y	边长
J1	2115538.098	463527.346	93.91
J2	2115611.052	463586.488	66.61
J3	2115665.156	463625.342	30.21
J4	2115689.698	463642.967	49.36
J5	2115729.785	463671.762	14.05
J6	2115721.451	463683.070	23.91
J7	2115701.764	463669.498	15.29
J8	2115689.173	463660.817	42.58
J9	2115654.621	463635.935	30.15
J10	2115629.991	463618.555	24.87
J11	2115610.022	463603.723	32.54
J12	2115584.200	463583.924	22.46
J13	2115566.694	463569.846	48.81
J14	2115529.422	463538.332	14.00
J1	2115538.098	463527.346	
S=3525.0 平方米 合5.2875亩			

地块二十八界址点坐标表

点号	X	Y	边长
J1	2115048.766	463351.439	5.40
J2	2115046.169	463356.173	19.96
J3	2115059.506	463371.028	39.08
J4	2115087.050	463398.745	58.22
J5	2115129.819	463438.253	77.30
J6	2115190.086	463486.666	5.77
J7	2115194.563	463490.309	2.08
J8	2115196.537	463489.647	30.77
J9	2115172.476	463470.461	33.48
J10	2115146.784	463448.989	30.32
J11	2115124.090	463428.879	24.50
J12	2115106.319	463412.012	19.97
J13	2115092.134	463397.960	43.71
J14	2115062.193	463366.121	19.90
J1	2115048.766	463351.439	
S=660.3 平方米 合0.9904亩			

地块二十六界址点坐标表

点号	X	Y	边长
J1	2115392.383	463409.219	160.70
J2	2115517.216	463510.418	13.37
J3	2115508.916	463520.905	41.40
J4	2115477.200	463494.298	41.40
J5	2115445.483	463467.692	34.53
J6	2115418.792	463445.787	40.34
J7	2115387.952	463419.789	9.72
J8	2115390.617	463410.445	2.15
J1	2115392.383	463409.219	
S=1942.2 平方米 合2.9133亩			

